

COMMUNITY FEEDBACK



Steering Committee

The Toledo Steering Committee has asked for safer connections for both bikers and pedestrians crossing US Highway 63 trying to get to Toledo's downtown.

COMMUNITY ENGAGEMENT RESPONSE

"Better Downtown Streetscapes"



Steering Committee

The High Street and Highway 63 intersection is an important gateway for downtown Toledo, as most traffic coming through both communities uses the US Highway 63 corridor. The Toledo Steering Committee has asked to improve the downtown streetscapes of Toledo, encouraging visitors and residents to spend more time on Main Street. The entrance to High Street acts as a gateway in both concepts, conducting viewers towards Toledo's downtown.

"Better Pedestrian Connections"



Active Adults



Parents



Kids

According to the Toledo Priorities, residents felt that better pedestrian connections was the third most important Transportation Enhancement Issue. Both concepts provide safe crossing across both streets by providing crosswalks, slowing traffic, and shortening the distance for pedestrians to cross. The proposed sidewalks along US Highway 63 and High Street that are a part of the Toledo Heights Connection Plan will help to provide a more complete pedestrian network for active adults, parents and their children.

"More Accessibility for Seniors"



Older Adults



Mobility Challenged

The Toledo Priorities also identified lack of access for seniors and the mobility challenged as a Transportation Enhancement Issue, and the design concept for High Street and US Highway 63 addresses this issue by providing ADA curb ramps with detectable warning strips at the end of all proposed crosswalks. Yield and stop signs are also proposed to slow incoming traffic and make drivers more aware of potential pedestrian presence, creating a safer crossing environment.

Toledo

High St + US 63

CONCEPT ONE - Tactical Urbanism Approach

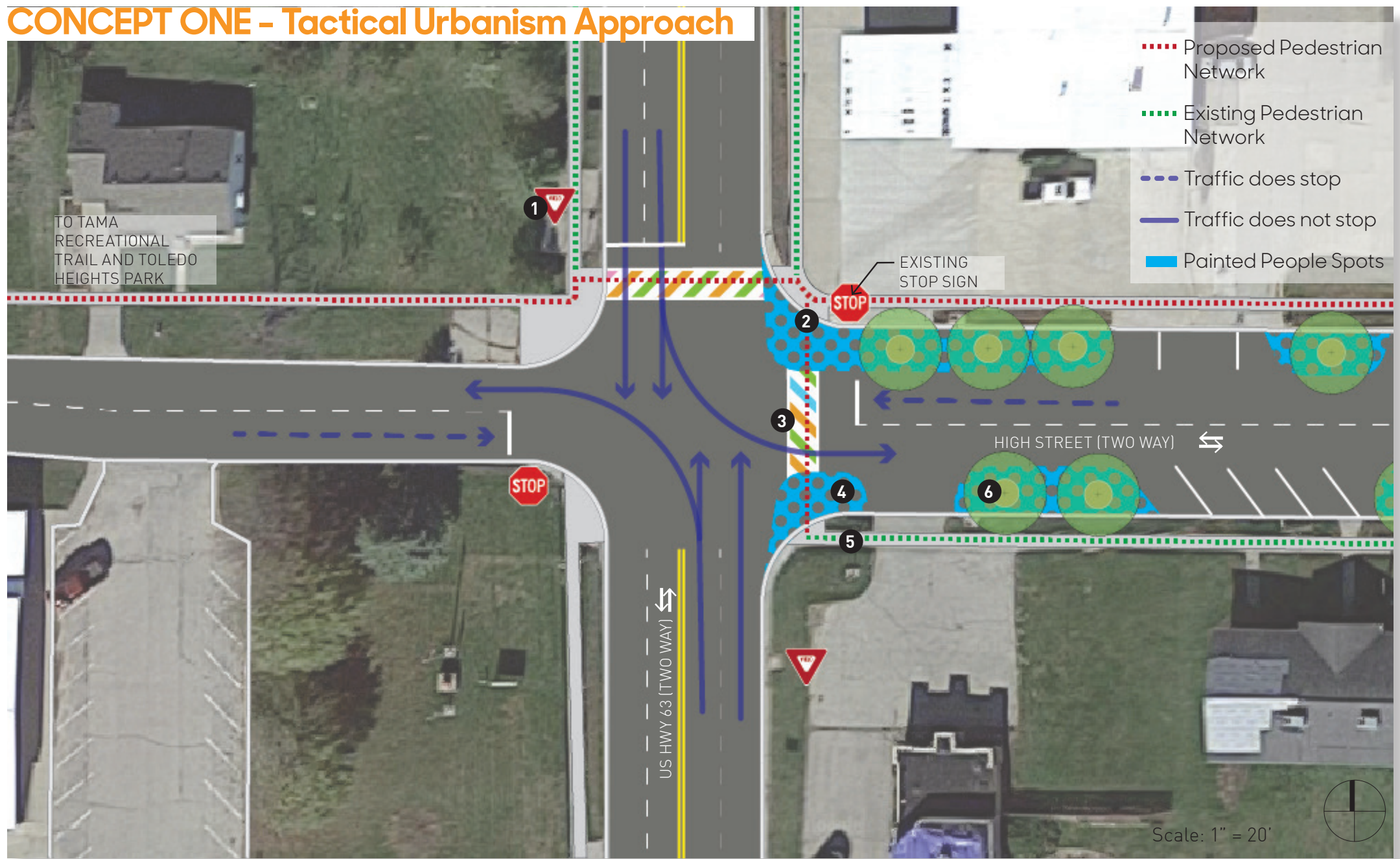

LEGEND:

- 1 Yield Sign
- 2 ADA Curb Ramp - Curb ramp with ADA detectable warnings.
- 3 Crosswalk - Ladder style crosswalk at least 6' wide to prioritize and emphasize pedestrian crossings.
- 4 Painted Curb Bump-out - Painted area on the existing street that shortens the distance pedestrians have to walk while crossing the street, increasing safety. Protected by flexible delineators.
- 5 New Sidewalk - 6' wide (minimum) concrete sidewalk connection.
- 6 Street Trees

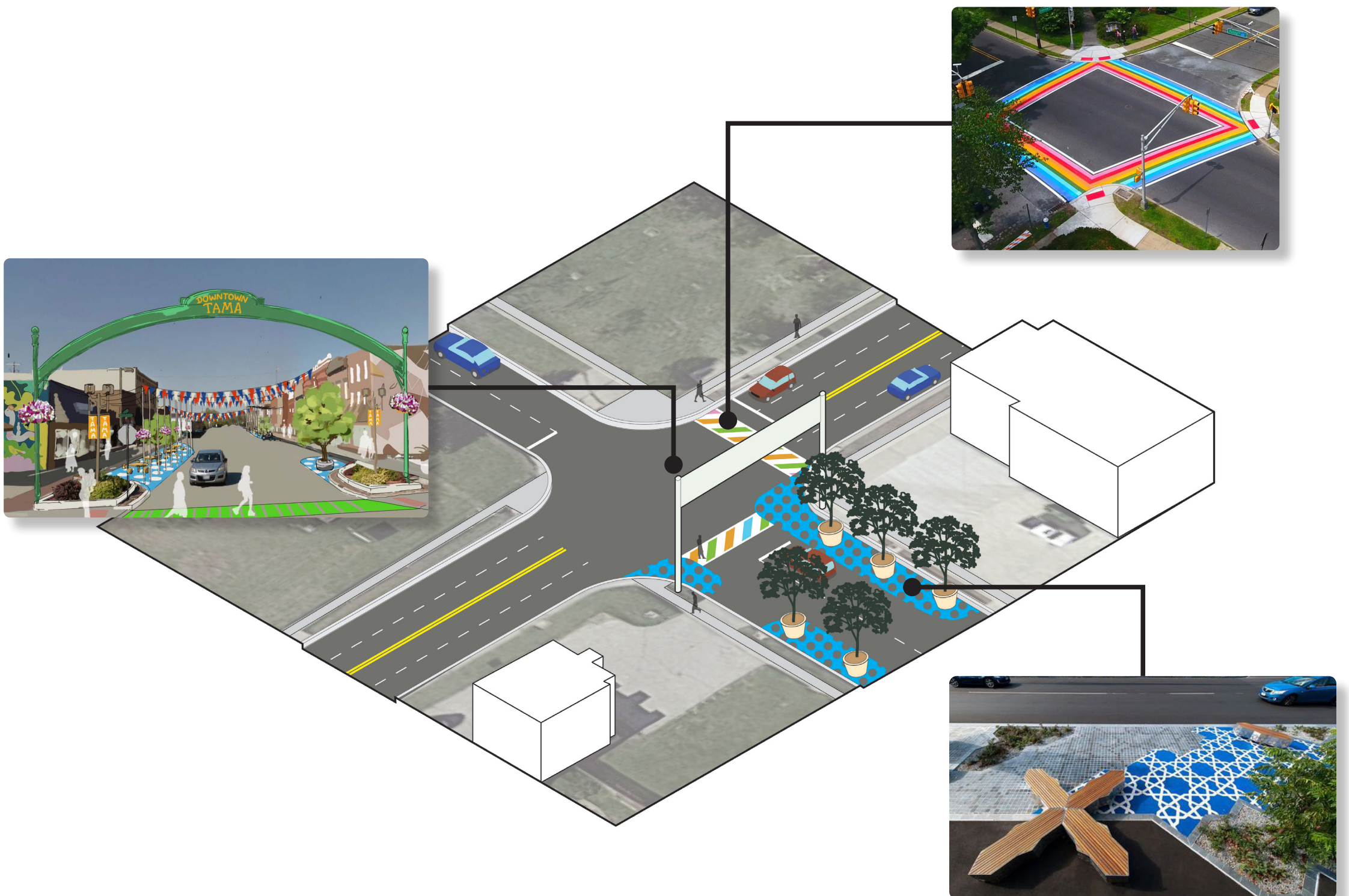

site design group

LA: Cassandra Rice, PLA, ASLA, Hana Ishikawa, AIA

Landscape Designer: Richard Meagher

Intern: Paul Hsu

CONCEPT TWO - Enhanced Connections & Permanent Streetscape Improvements

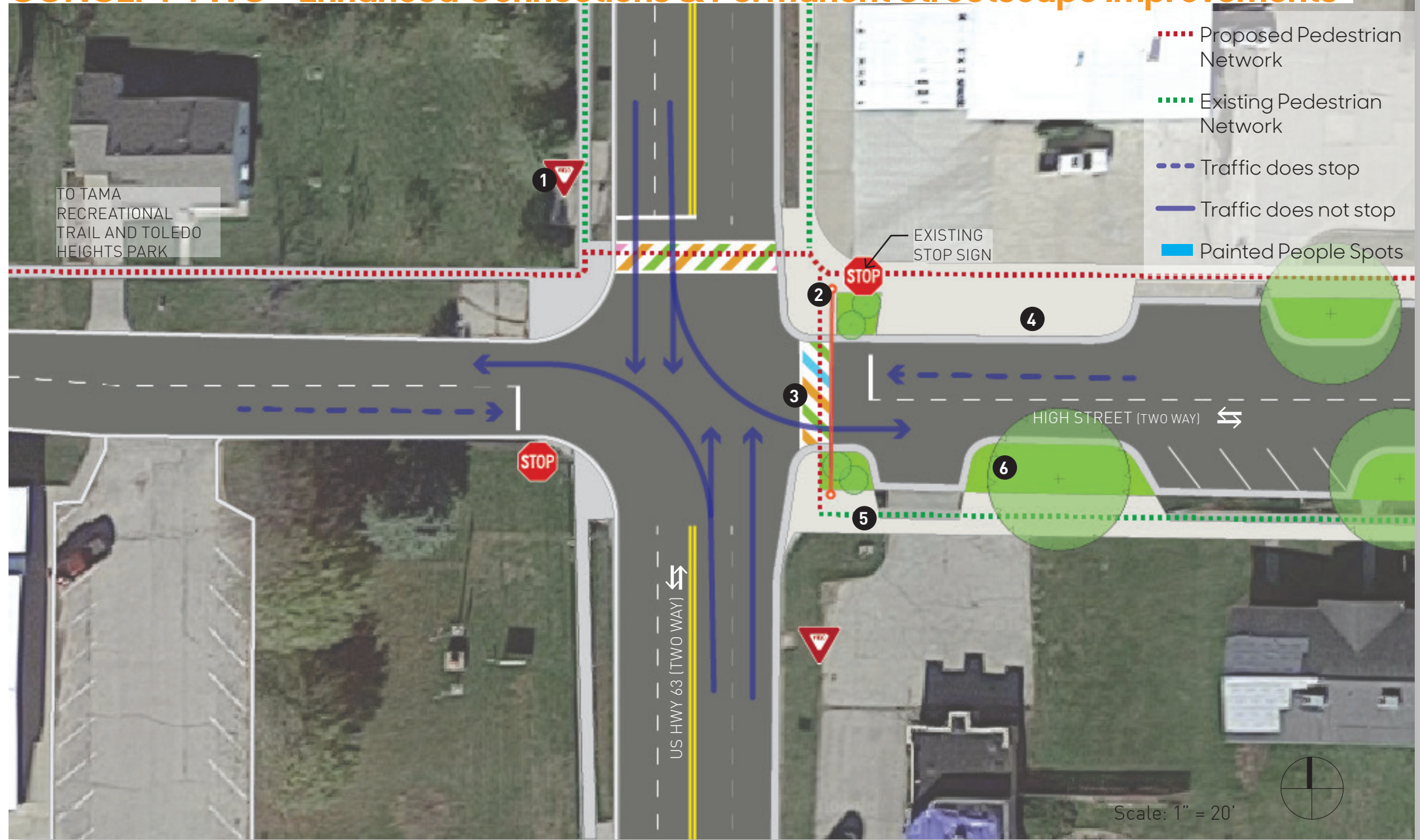

LEGEND:

- ① Yield Sign
- ② Downtown Toledo Entry Gateway
- ③ Crosswalk - Ladder style crosswalk at least 6' wide to prioritize and emphasize pedestrian crossings.
- ④ Constructed Curb Extension- potential for outdoor dining spaces, seating, public art, and other public realm improvements
- ⑤ New Sidewalk - 6' wide (minimum) concrete sidewalk connection.
- ⑥ Street Trees

